

Vedere.

Gara de Triaj din Stația Pallas.  
Castel de apă de 60 m<sup>3</sup>.

Diracțiunea Generală a C. & R.  
Serviciul Soturilor.

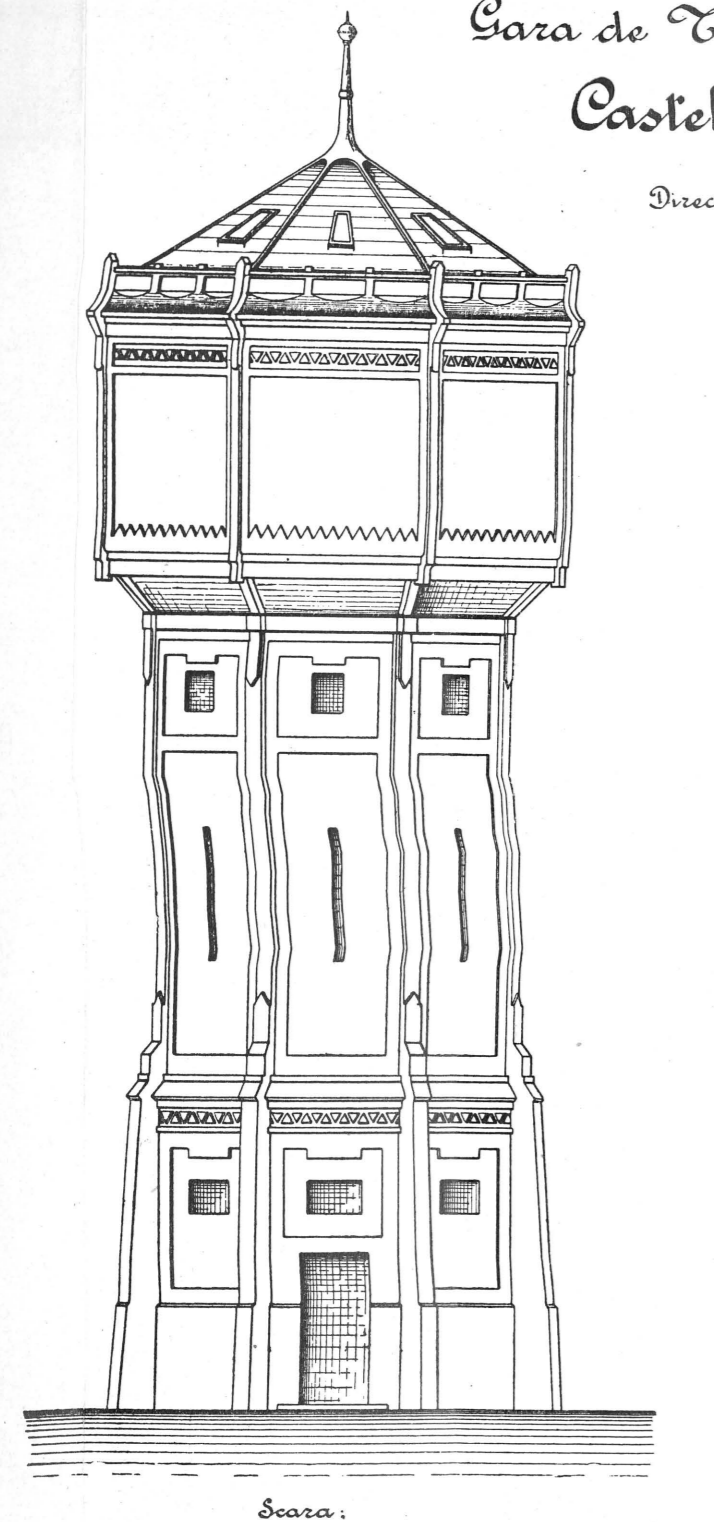

Secție longitudinală.

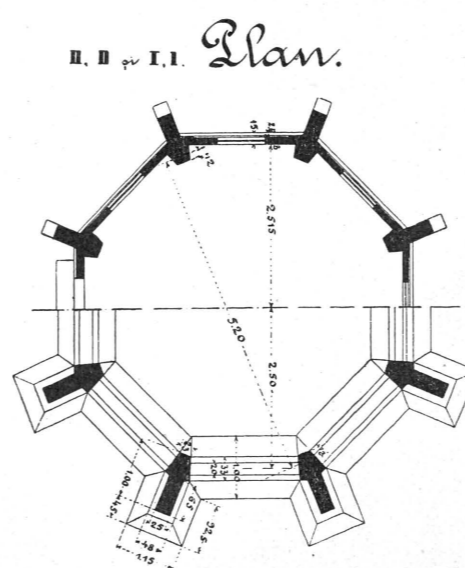
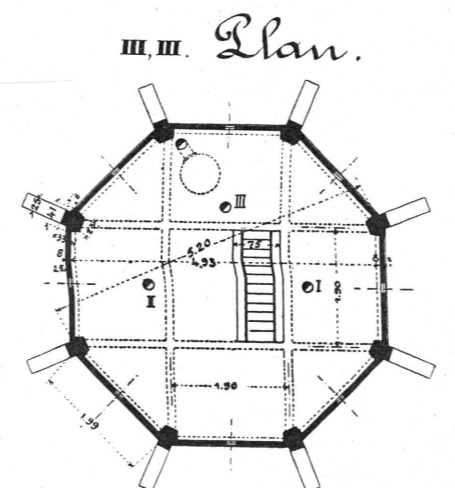
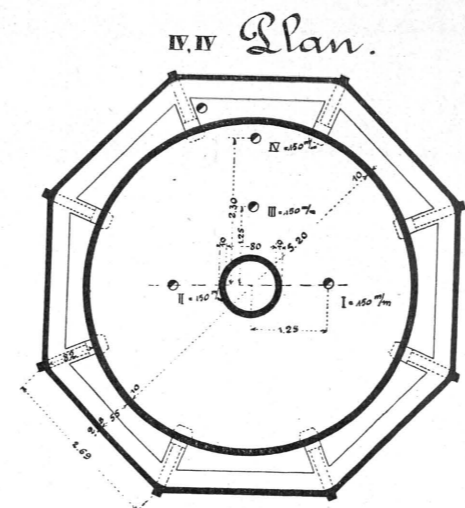
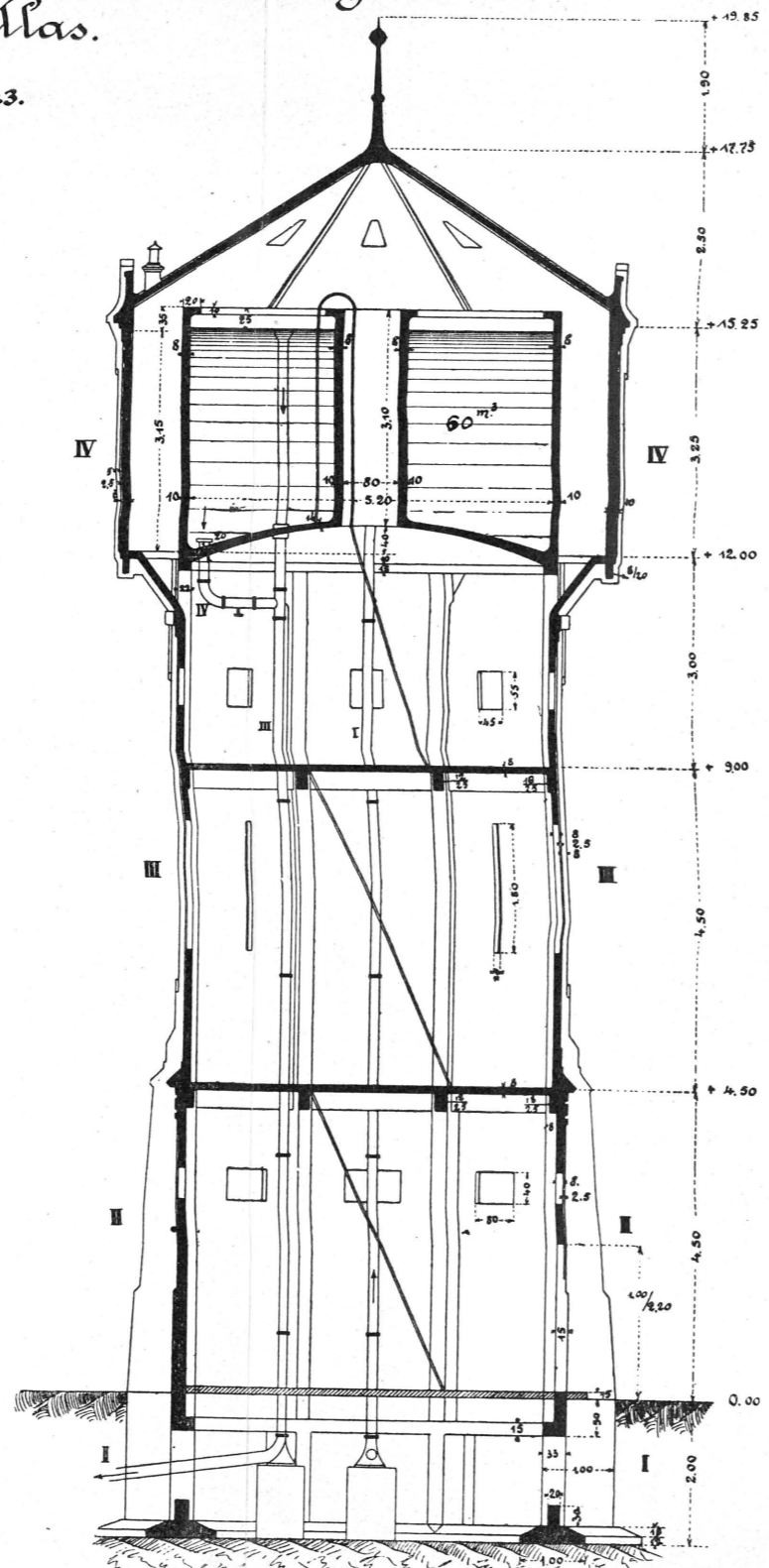

Secție longitudinală prin rotativiu.

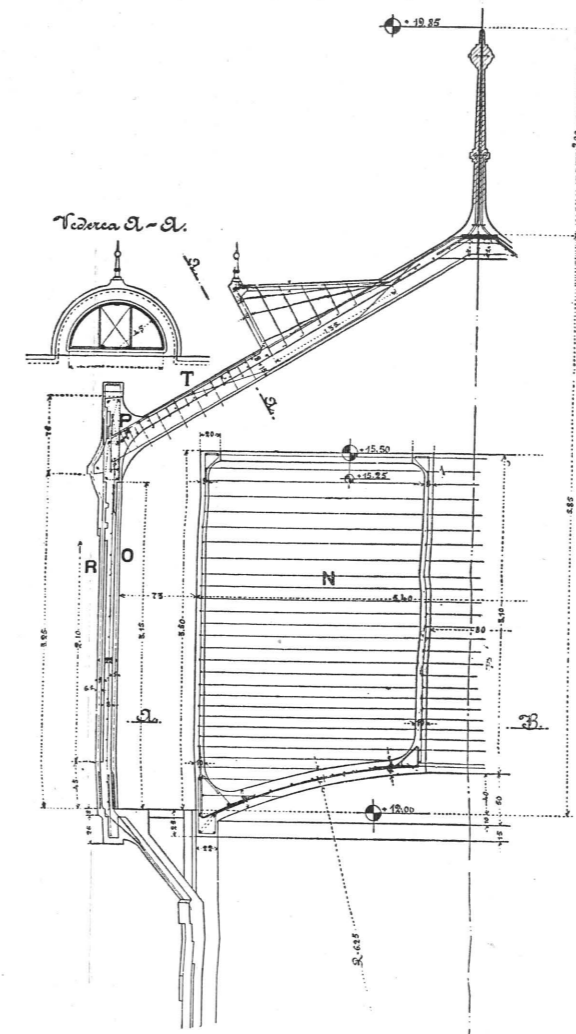

Secția A-B.

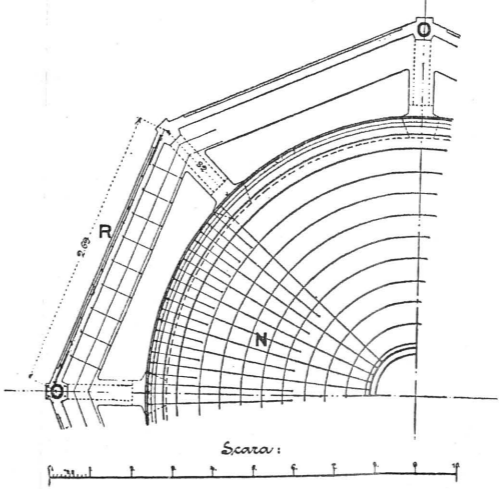

Gara de triaj din Stația Pallas.  
Castel de apă de 60 m<sup>3</sup>.

Secție longitudinală.

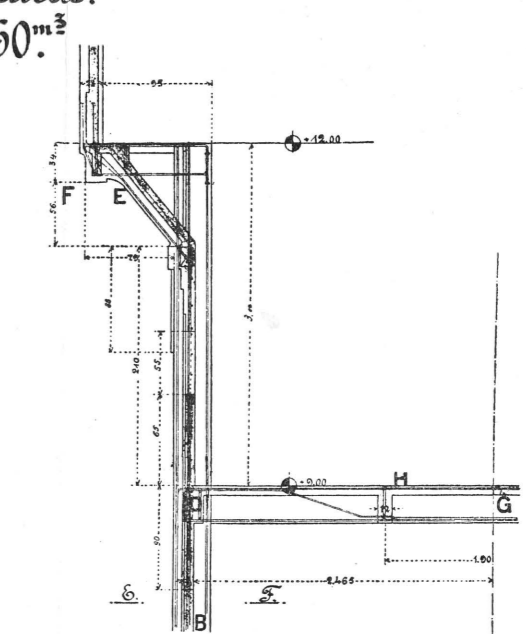

Secția stălpului.

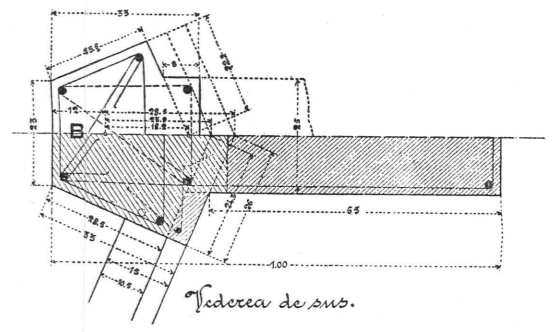

Vezi de sus.

